

Classrooms - Schools Buildings

Whitley Model MDL - 5215

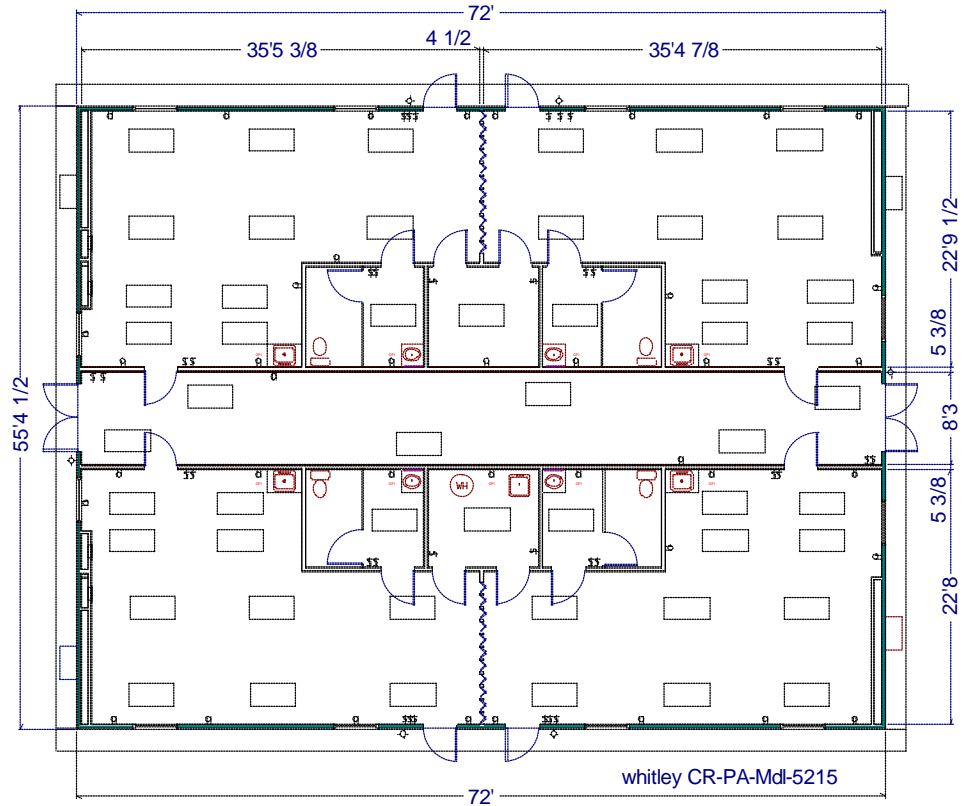

Photos are for illustration - see model # specifications for actual items and finishes..

See our web site
(www.whitleyman.com) for:

- additional floor plans.
- specifications.
- installation information.
- interior and exterior finishes.
- loan calculator.
- photos and floor plans album.
- other information regarding modular buildings.

