

Model MO-264-2257-2
Relocatable.

LABORATORY BUILDINGS

whitley 12/03



Photos are for illustration - see model # specifications for actual items and finishes..

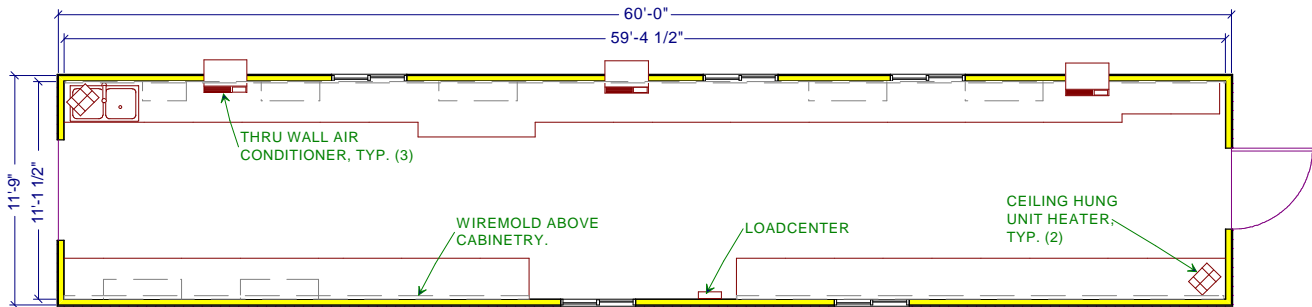

whitley MO-264-2257-2
BUILDING AREA
705 sq ft

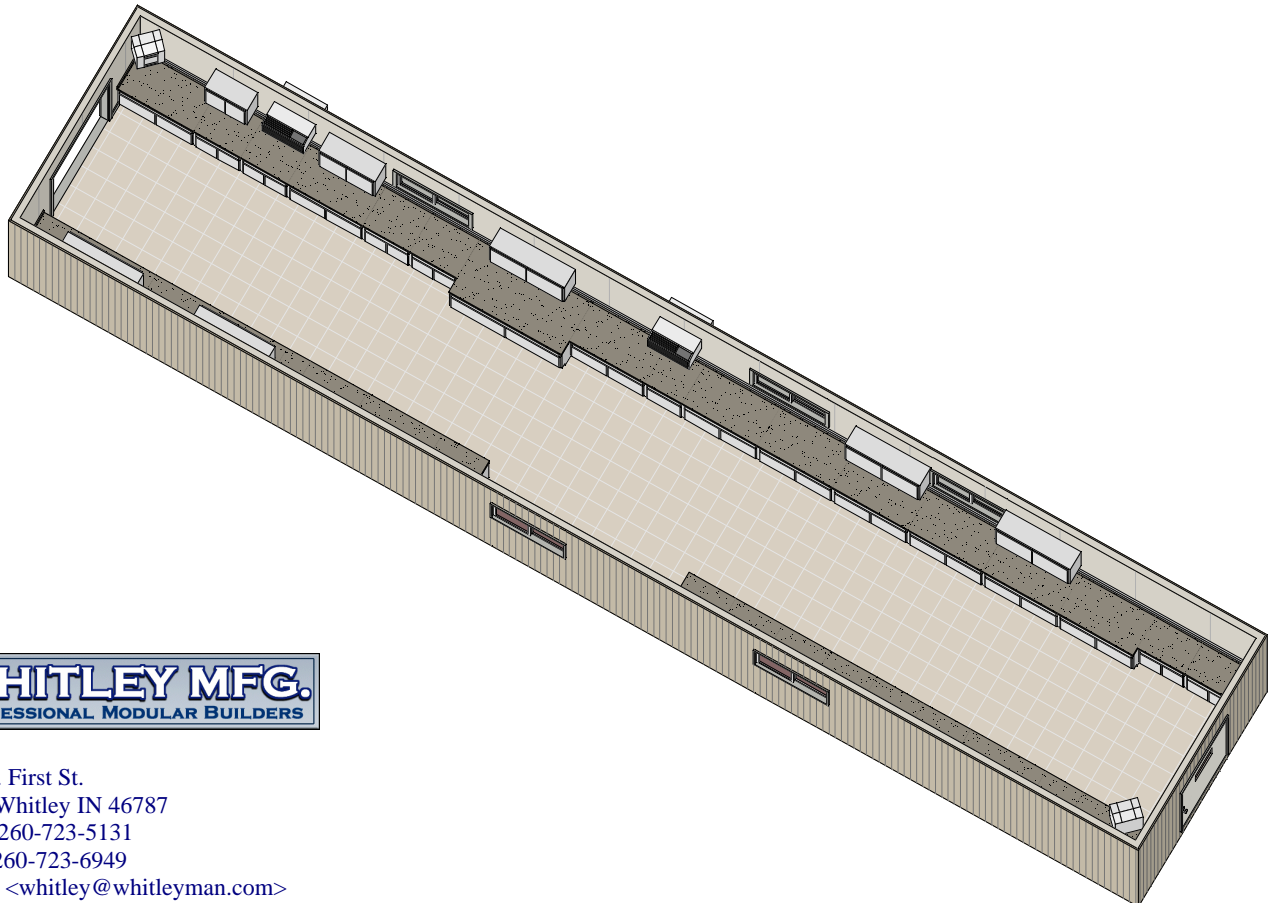

201 W. First St.
South Whitley IN 46787
Phone 260-723-5131
Fax 260-723-6949
E-Mail <whitley@whitleyman.com>
Internet <<http://www.whitleyman.com>>

South Whitley IN Marysville WA, Rochester, IN